

| OPPERVLAKTES | |
|---------------|----------------------------|
| Appartement | 99.11m ² |
| Terras | 7.00m ² |
| Kelder | 2.95m ² |
| Parking | 18.13m ² |
| TOTAAL | 127.19m² |

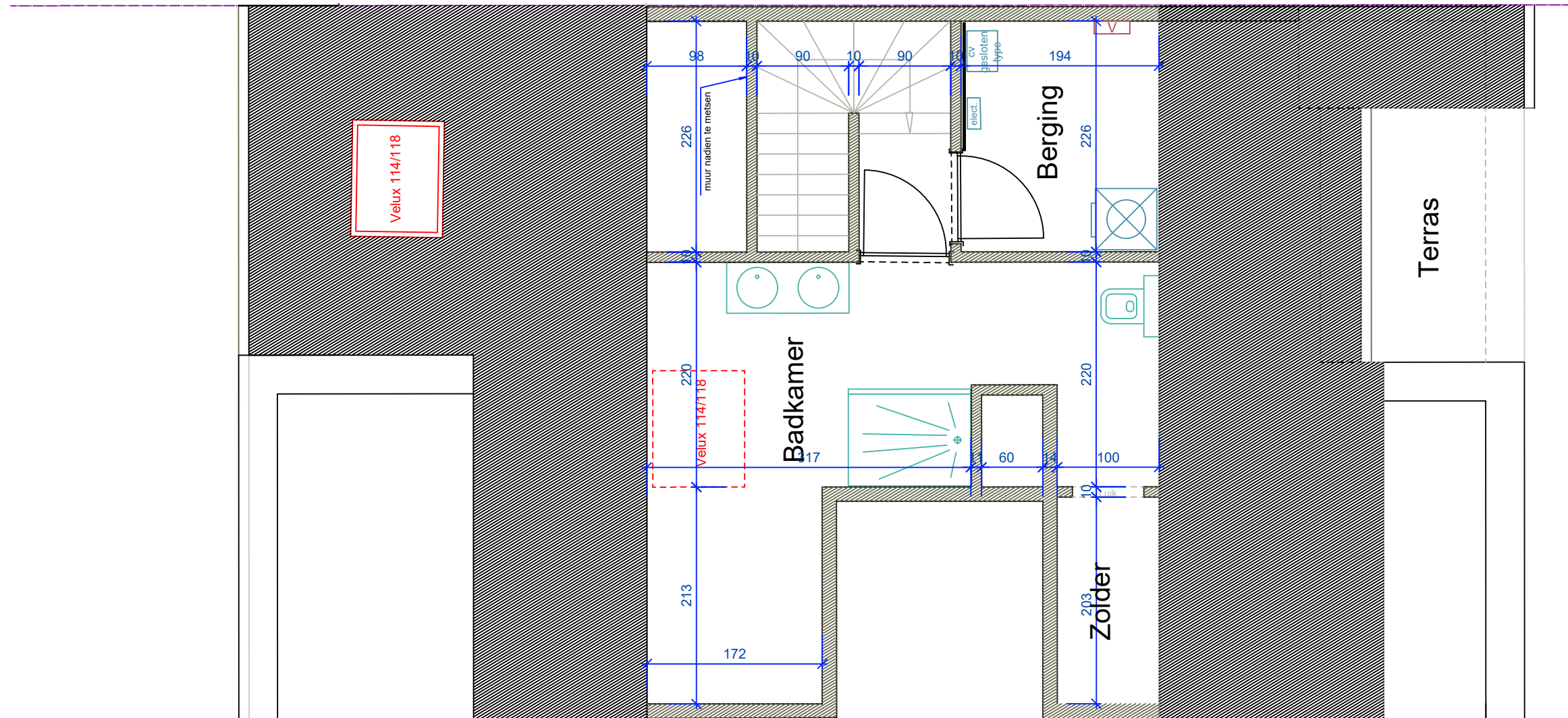

| | | |
|---------------------------|---|--------------------------|
| RESIDENTIE VIK | Duplex App. A2 - Kelder nr 2 - Parking nr 14 Hoek Brusselsesteenweg / Hofkwartier Meerbeke 9402 | |
| | DATUM: 09/08/2017 | FORMAAT A3 - SCHAAL 1:50 |
| | | PLAN NR 2/2 |

**TRAWOBO
INVEST**

EDGARD TINELSTRAAT 18 BUS 1 - SINT-LIEVENS-HOUTEM <http://www.trawobo-invest.be> info@trawobo-invest.be

Gregory:
0499 36 17 83

Shana:
0472 76 10 41